

2018

Beta

1493Y 1- 2SELF-LOCKING OIL FILTER WRENCHES LEFT AND RIGHT HAND TIGHTENING



Heavy series



Version 104÷150 mm
is suitable also for
filter driers



2018

1530/C16 Extractor for hubs with spacers

Beta

The kit includes:

- 1 universal flange 90 ÷ 130 mm
- 15 kg sliding hammer
- 4 columns with M12 connection
- 4 columns with M14 connection



2018

1758 SELF-ADAPTING FUNNEL

Beta

particularly useful for cars with no depth inside the inlet plug

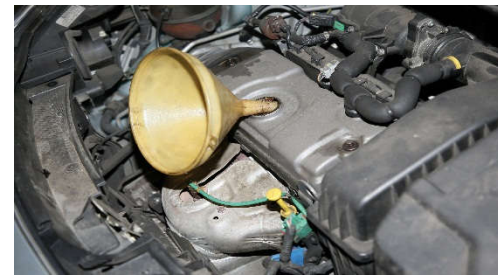

2018

1889CF UNIVERSAL BARREL OPENING WRENCH

Beta

- 1 female hexagon \varnothing 38 mm
- 1 4-sector profile \varnothing 42 mm
- 1 blade 17x7 mm



2018

Beta

962M TYRE MOUNTING/DISASSEMBLY TOOL

- non-scratch rim locking jaws
- tyre removal lever seat



Runflat mounting for all the
Tyre changers



2018

986PT PRECALIBRATED SCREWDRIVER FOR TYRE VALVES

Beta

- Tyre valve screwdriver, precalibrated, 0.4 Nm
- Automatic valve retention
- Slip mechanism prevents valve core gasket from getting damaged

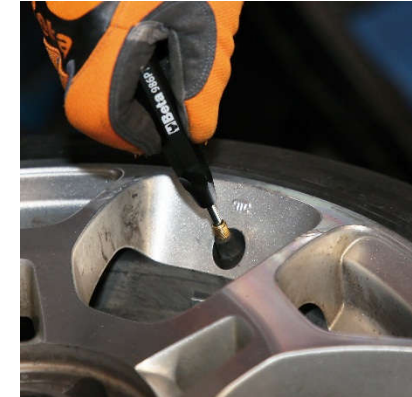

0,4 Nm

L mm 19
L1 mm 120



2018

Beta

987AR TYRE VALVE LEVER WITH NON-SCRATCH FULCRUM

- rubber and nylon fulcrum for alloy and iron rims
- valve quick coupling, does not require screwing

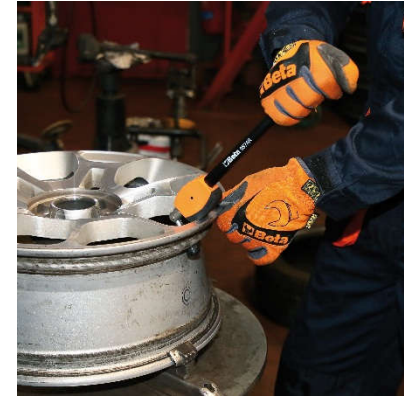

L=305mm



2018

962P 490 TYRE LEVERS WITH NON-SCRATCH RUBBER PROTECTION

Beta

L mm 490
L1 mm 25

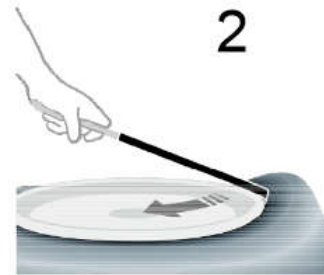
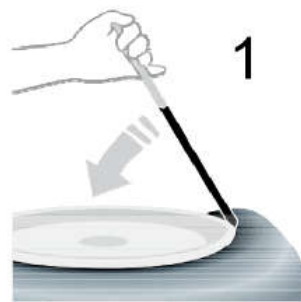

2018

WHAT'S SPOTTER?

Beta



Spotter is a specific electric tool for repairing car body.

It brings in the correct position the car body damaged.

2018

SPOTTER ON THE MARKET

Beta

Traditional design



25÷40 kg

For work is necessary to buy a trolley or similar



2018

Beta

1366S WHEEL BODYWORK SPOTTER

- microprocessor for managing welding parameters
- welding power and time adjustment
- **adjustment range: 400÷2200 Ah**
- single, pulsed, continuous point selector
- welding parameters table
- thermal protection indicator
- quick coupling gun
- voltage: 230 V

THERE'S A SPOTTER AND A TROLLEY INCLUDED

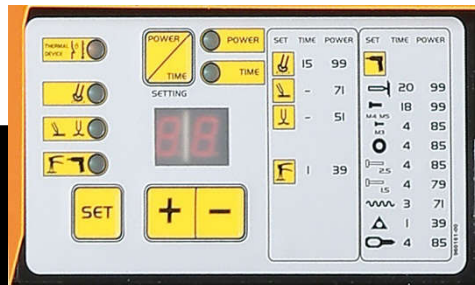

2018

Beta

1366S SPOTTER ACCESSORY KIT

- 10 slot washers
- 10 90° slot washers
- 100 threaded dowels 5x18 mm
- 100 self-tapping dowels 5x18 mm
- 100 self-tapping dowels 5x25 mm
- hook for washers \varnothing 8x16x1,5 mm
- electrode for screws M5-M6
- electrode for slot washers

KIT ACCESSORIES FOR SPOTTER 1366S KIT



1366SL PULLING LEVER TO REPAIR DENTS

articulated multihook head
to be used with crimped wire



1366S T CROSSBAR TO REPAIR DENTS ON METAL SURFACES

articulated multihook head
to be used with crimped wire

2018

Beta

New ACTIVE line



7314AB
«Active»
S1P SRC



7314AF
«Active»
S1P SRC



7315AN
«Active»
S3 SRC



2018

7314AB

7314AF

S1P SRC

Beta

- **UPPER:** Suede with nylon mesh and carbon inserts
- **OUTSOLE:** Dual density polyurethane
- **TOE CAP:** Polymer material, 200 joules
- **PENETRATION-PROOF INSOLE:** Composite fibre, ceramic treatment
- **UNDERFOOT COVER:** Anatomically shaped, with cushioning heel lift
- **WEIGHT (size 42):** 550 g
- **SIZES:** from 35 to 48



7314AB



7314AF



2018

7315AN

Beta

- **UPPER:** Suede and microfibre, waterproof, with carbon inserts
- **OUTSOLE:** Dual density polyurethane
- **TOE CAP:** Polymer material, 200 joules
- **PENETRATION-PROOF INSOLE:** Composite fibre, ceramic treatment
- **UNDERFOOT COVER:** Anatomically shaped, with cushioning heel lift
- **WEIGHT (size 42):** 550 g
- **SIZES:** from 35 to 48

S3 SRC

7315AN



2018

Beta

7984G

NOVITÀ

Work belt,
100% TPE, with chrome-plated
zinc metal buckle,
one size: 125 cm - can be
shortened; width: 35 mm,
black



Sleeveless Jacket,

- Outer fabric: nylon 20D
- Padding: down-like polyester, 80 g/m2

Special PRICE

Supplied in a convenient, room-saving bag, for maximized jacket compactness



- Two waist pockets with zip closure
- Two interior pockets



7687GV

S	076870101
M	076870102
L	076870103
XL	076870104
XXL	076870105
XXXL	076870106

7687GG

S	076870201
M	076870202
L	076870203
XL	076870204
XXL	076870205
XXXL	076870206

Stretch waist tape